

This walkway is made from the Flagstone Floor Tile Mold #260

1

2

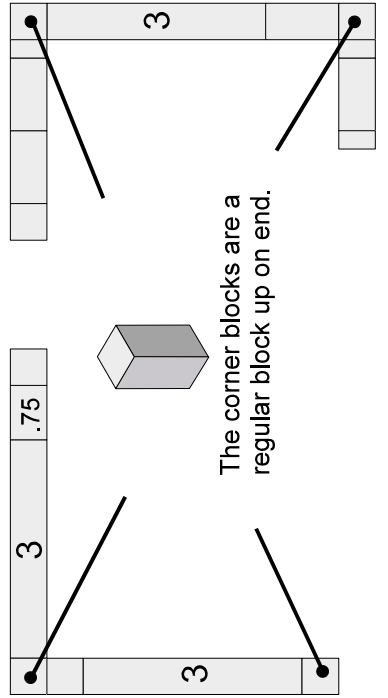

3

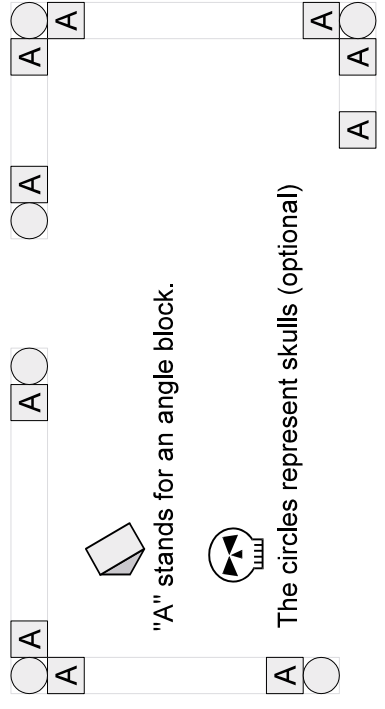

The Warlock House

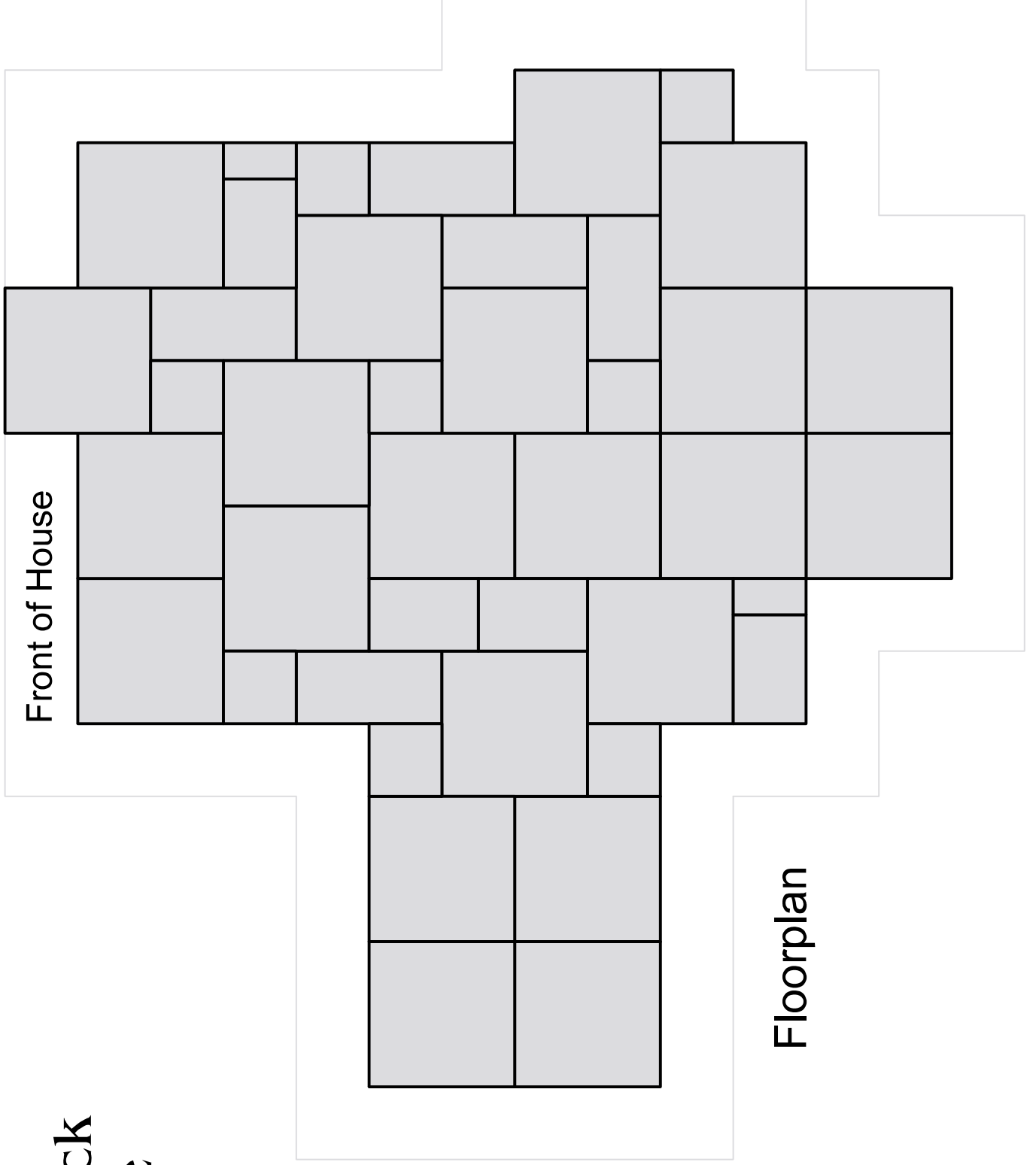

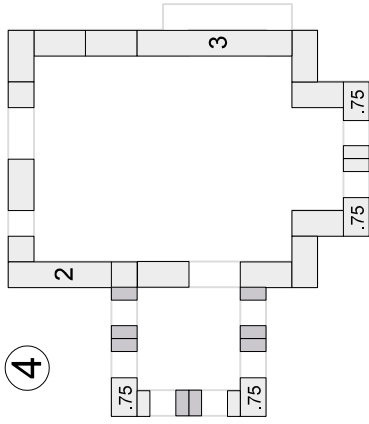
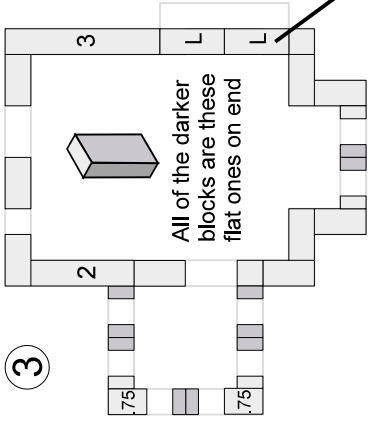
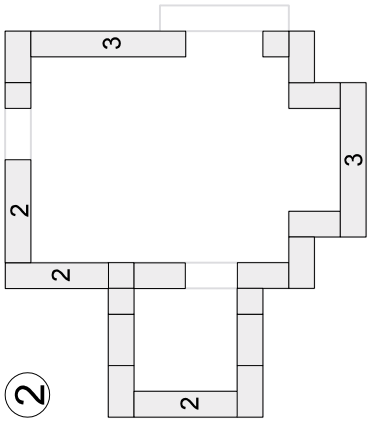
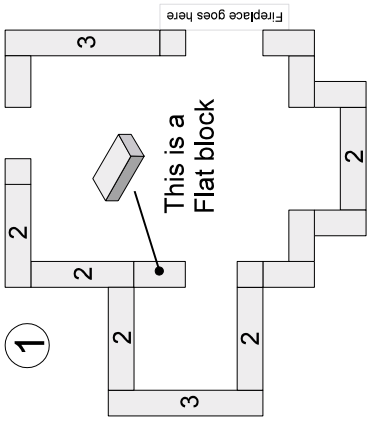

"M" represents the medium arch piece

"S" represents the smallest arch piece



"L" represents the longest arch piece

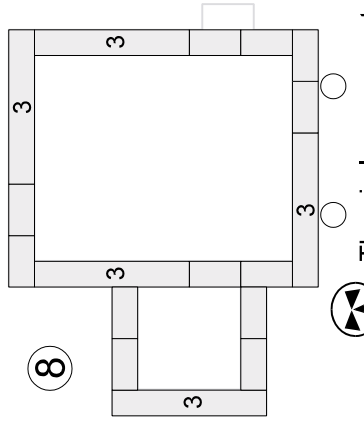
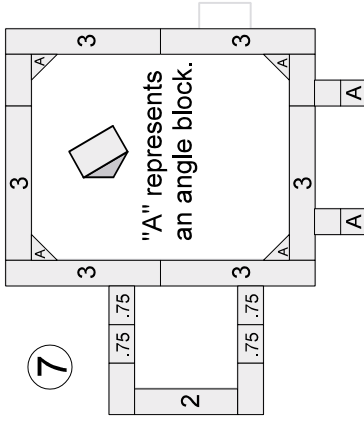
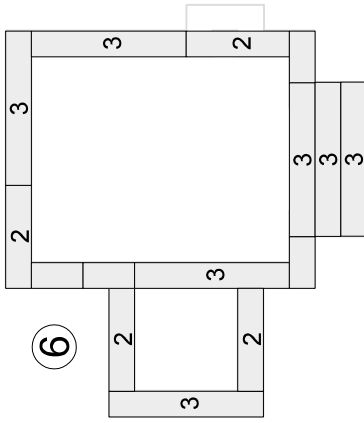
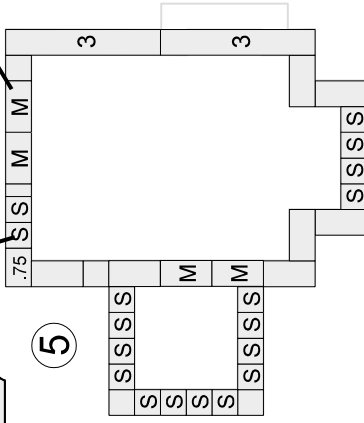

The circles represent skulls (optional)

The floor is made from the Flagstone Floor Tile Mold #260

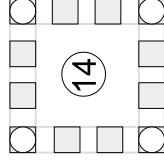
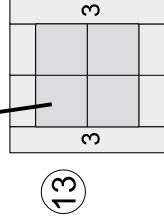
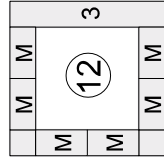
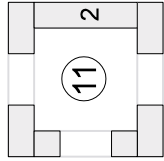
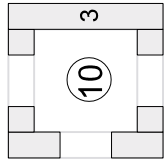
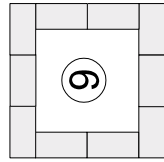

The Warlock House

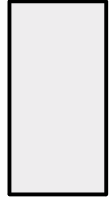
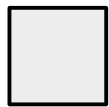

These are the actual sizes of the blocks. I only labeled the ones which are more difficult to tell the length of. The unlabeled ones are 1/4" (flat block), 1/2" long (square block) and 1" long (regular block).

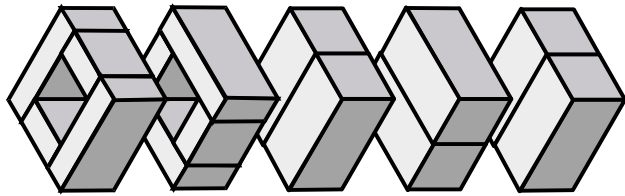

Chimney Top

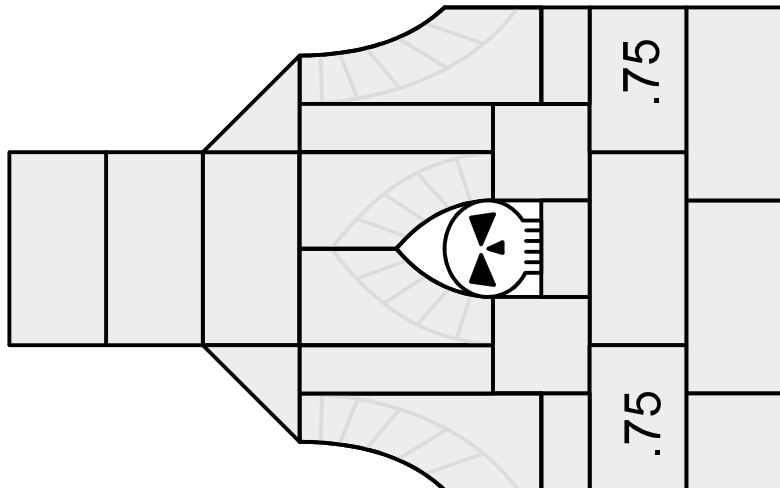

Chimney Bottom

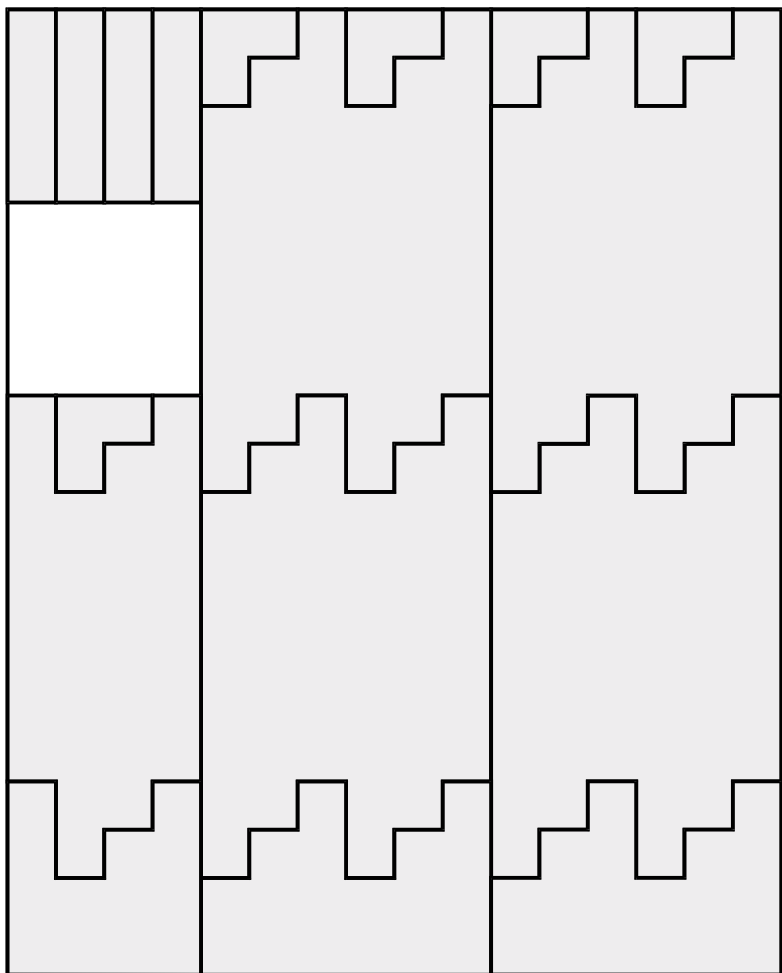

These edges must be scored and broken.

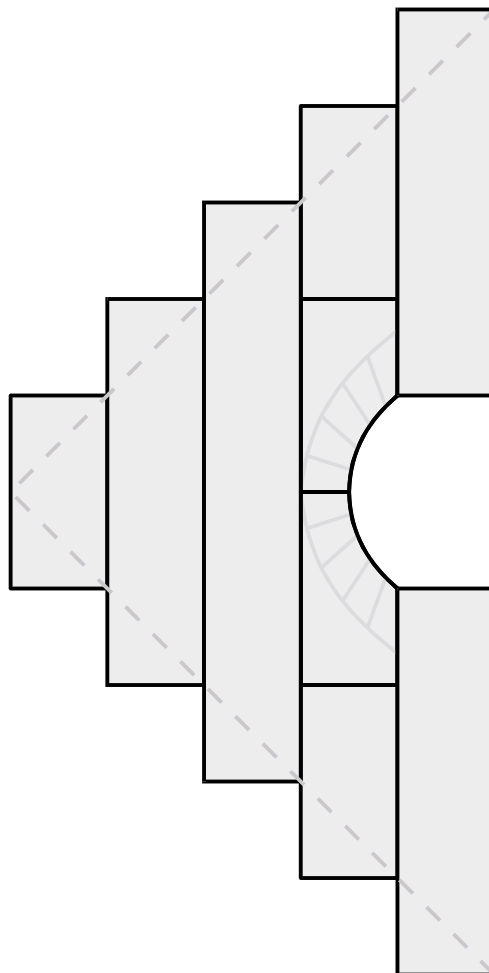

Sand down each slope of the roof until it reaches the dashed line.

Make 2 of these roof peaks

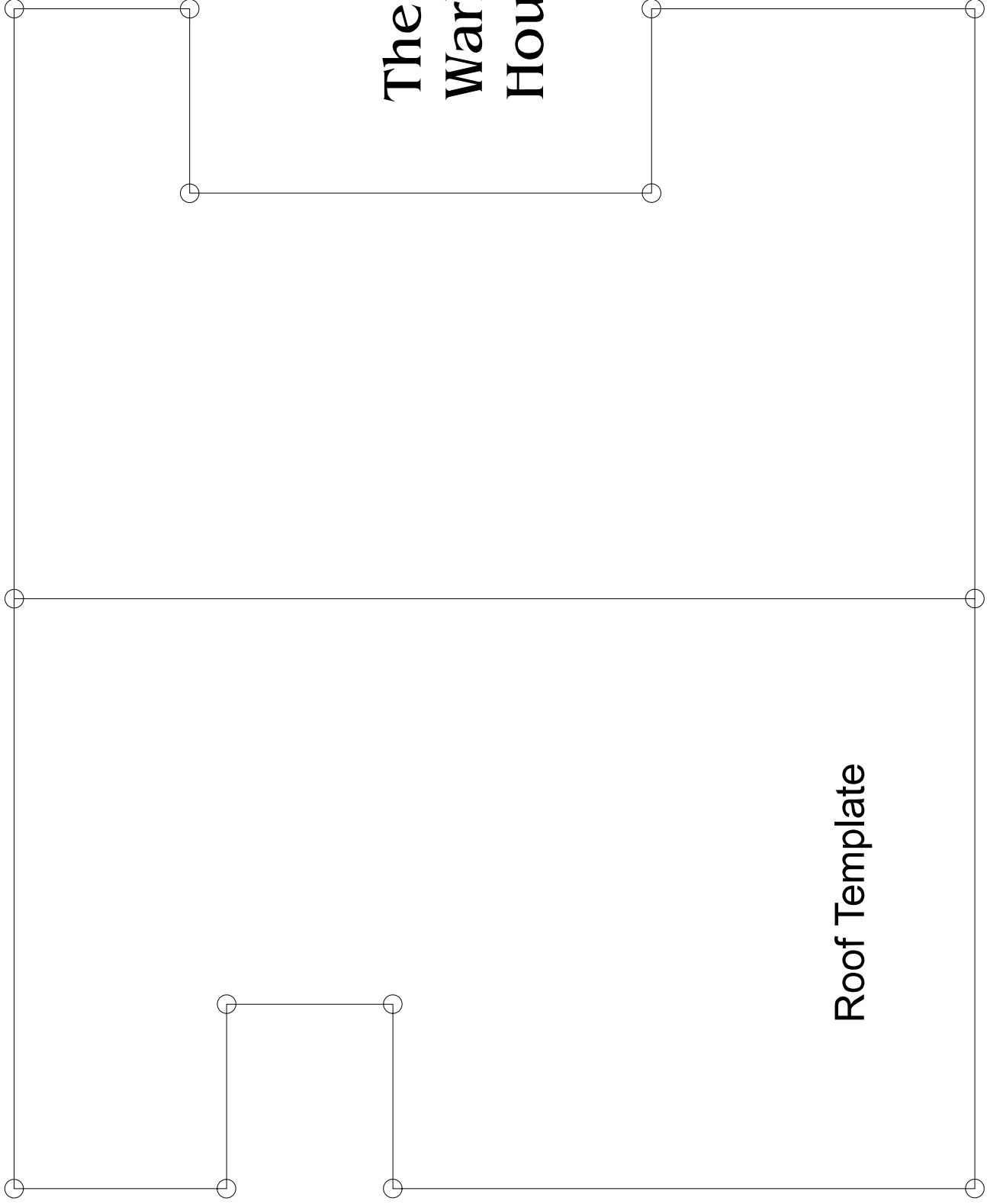

The
Warlock
House

Roof Template